



ST78-5

Infrared Sensor Lamp



Instruction

Welcome to use our ST78-5 Infrared Sensor Lamp!

The product is an energy-saving automatic sensor lamp, adopting integrated circuit and precise detecting components. It gathers automatism, convenience, safety, saving-energy and practical functions. Its performance is stable. It can identify day and night. The lamp can turn on when one enters detection field and can turn off automatically when one leaves detection field.

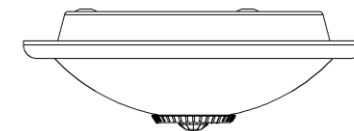

SPECIFICATION:

Power Source: 220-240V/AC

Power Frequency: 50/60Hz

Ambient Light: <3-2000LUX (adjustable)

Time Delay: Min.10sec ± 3sec

Max.3min ± 30sec

Rated Load: Max.2x40W (E27)

Detection Range: 360°

Detection Distance: 6m max(<24°C)

Working Temperature: -20~+40°C - IP20

Working Humidity: <93%RH

Installation Height: 2.2-4m

Detection Moving Speed: 0.6-1.5m/s

FUNCTION:

- Can identify day and night: The consumer can adjust working state in different ambient light. It can work in the daytime and at night when it is adjusted on the "sun" position (max). It can work in the ambient light less than 3LUX when it is adjusted on the "moon" position (min). As for the adjustment pattern, please refer to the testing pattern.
- Time-Delay is added continually: When it receives the second induction signals within the first induction, it will restart to time from the moment.
- Adjustable Time Delay: the length of time delay could be set according to the customers' requirement, the minimum time of this item is 10sec ± 3sec, the maximum is 3min ± 30sec.

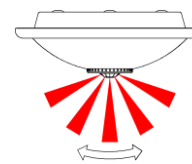

Good sensitivity

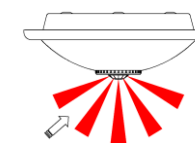

Poor sensitivity

INSTALLATION:

- Switch off the power.
- Unscrew the plastic screw nut and remove the glass lampshade.(refer to figure1)
- Pass the wire through the hole in the bottom and connect the power wire into connection-wire column according to the connection-wire diagram. Install the sensor lamp in the position where you need with inflated screws. (refer to figure2)
- Enclose the incandescent bulbs or energy-saving lamps. Install back the lampshade, then electrify and test it.(refer to figure3)

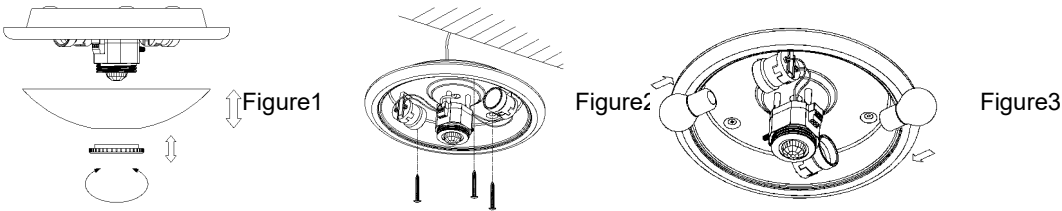

CONNECTION-WIRE DIAGRAM:

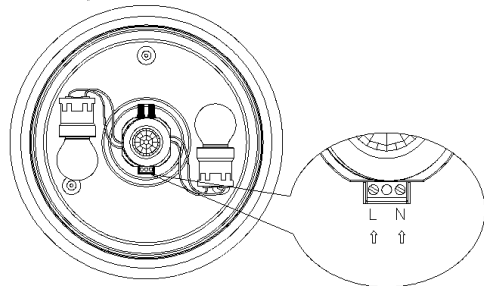

SENSOR INFORMATION:

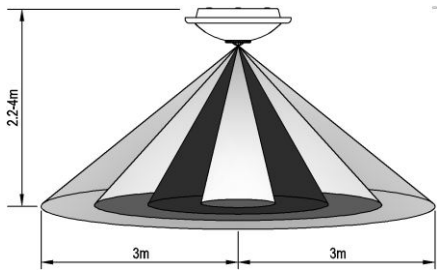

Height of installation: 2.2-4m

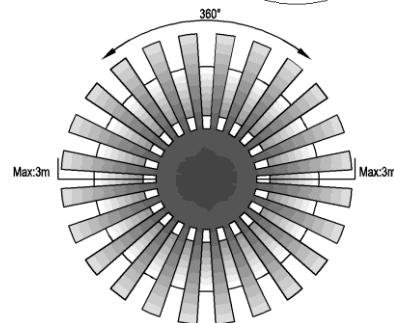

Detection Distance: Max.6m

TEST:

- Turn the TIME knob anti-clockwise on the minimum. Turn the LUX knob clockwise on the maximum (sun).
- Switch on the power; the lamp will have no signal at the beginning. After Warm-up 30sec, the lamp can start work .If it

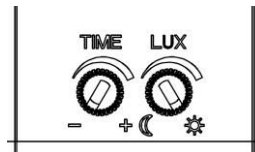

receives the induction signal, the lamp will turn on. While there is no another induction signal any more, the lamp should stop working within $10\text{sec} \pm 3\text{sec}$.

- Turn LUX knob anti-clockwise on the minimum (moon). If the ambient light is more than 3LUX, the lamp should not work. If the ambient light is less than 3LUX (darkness), the sensor would work. Under no induction signal condition, the lamp should stop working within $10\text{sec} \pm 3\text{sec}$.

Note: when testing in daylight, please turn LUX knob  (SUN) position, otherwise the sensor lamp could not work!

NOTE:

- Should be installed by electrician or experienced person;
- Avoid installing it on the uneven object;
- There should be no hindrance and moving objects in front of the detection windows to affect detection;
- Avoid installing it near air temperature alteration zones such as air condition, central heating, etc;
- Considering your safety, please do not open the cover when you find the hitch after installation.
- If there is difference between instruction and the function the product has, please give priority to product and sorry not to inform you additionally.

SOME PROBLEM AND SOLVED WAY:

- The load does not work:
 - Please check if the connection of power source and load is correct.
 - Please check if the load is good.
 - Please check if the settings of working light correspond to ambient light.
- The sensitivity is poor:
 - Please check if there is any hindrance in front of the detector to affect it to receive the signals.
 - Please check if the ambient temperature is too high.
 - Please check if the induction signal source is in the detection field.
 - Please check if the installation height corresponds to the height required in the instruction.
 - Please check if the moving orientation is correct.
- The sensor can not shut off the load automatically:
 - Please check if there is continual signal in the detection field.
 - Please check if the time delay is set to the maximum position
 - Please check if the power corresponds to the instruction.